

RETROFIT OF AN URBAN ARTERIAL

Case Study of Main Street, Dartmouth

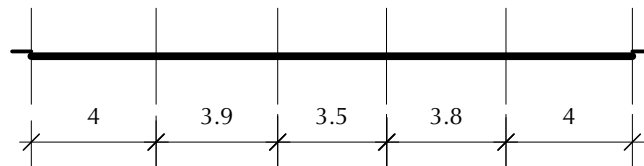

Outside Lane (EB) Inside Lane (EB) Centre turn Lane Inside Lane (WB) Outside Lane (WB)



EXISTING: Looking East



Looking West

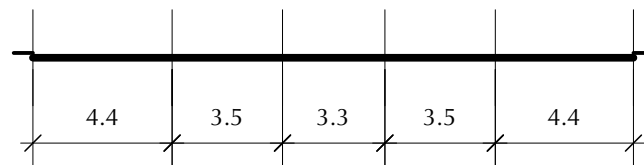

Wide Curb Lane (EB) Inside Lane (EB) Centre turn Lane Inside Lane (WB) Wide Curb Lane (WB)

POTENTIAL: OPTION 1 - WIDE CURB LANE Can be accomplished by reallocating space within the existing roadway according to Transportation Association of Canada (TAC) minimum recommended lane widths for Urban Undivided Arterial Roads. "Share the Road" signage and pavement markings are recommended to accompany this facility.

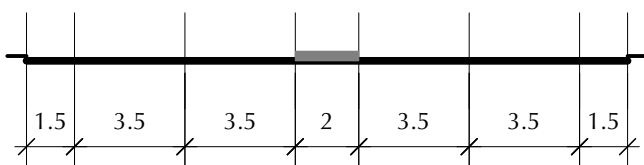

Striped Bicycle Lane (EB) Outside Lane (EB) Inside Lane (EB) Raised Median Inside Lane (WB) Outside Lane (WB) Striped Bicycle Lane (WB)

POTENTIAL: OPTION 2 - STRIPED BICYCLE LANE would require the elimination of the central turning lane. Traffic studies would be required.

1 Main Street East of Gordon Avenue

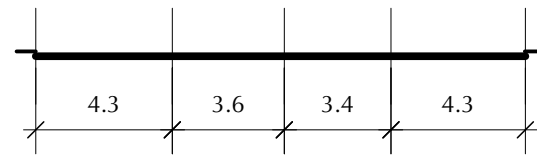

Outside Lane (EB) Inside Lane (EB) Inside Lane (WB) Outside Lane (WB)

EXISTING CONDITIONS
Wide curb lanes already exist. "Share the Road" signage and pavement markings could be introduced to compliment this facility and remind road users of the cyclist's legitimate place on the roadway. The position of the pavement marking can also serve to indicate to the cyclists their most appropriate location in the lane.



PAVEMENT MARKINGS
Currently being considered for use in HRM



SHARE THE ROAD SIGN AND TAB
Approved signage by the Transportation Association of Canada

2 East of Woodlawn at Community College, Akerley Campus

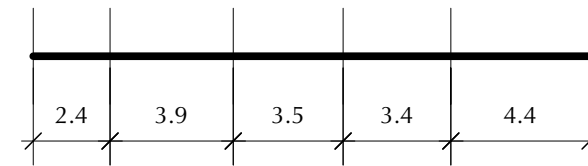

Unpaved Shoulder (EB) Outside Lane (EB) Inside Lane (EB) Inside Lane (WB) Outside Lane (WB)

EXISTING CONDITIONS
Wide curb lane in the westbound direction. 12'10" outside lane in the eastbound direction with an unpaved shoulder

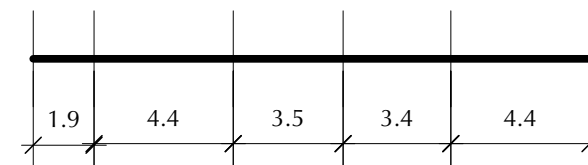

Unpaved Shoulder (EB) Wide Outside Lane (EB) Inside Lane (EB) Inside Lane (WB) Wide Curb Lane (WB)

POTENTIAL: OPTION 1 - WIDE CURB LANE: Paving a small portion of the shoulder in the eastbound direction will serve to better accommodate cyclists on a wide outside lane in that direction. In the westbound direction, a wide curb lane already exists adjacent to the curb. Share the road signage and pavement markings are also recommended to provide continuity along the Main Street facility.

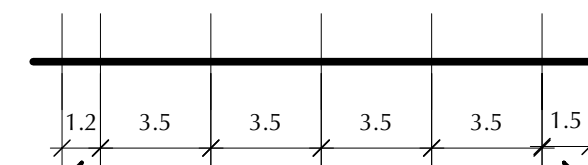

Striped Bicycle Lane (EB) Outside Lane (EB) Inside Lane (EB) Inside Lane (WB) Outside Lane (WB) Striped Bicycle Lane (WB)

POTENTIAL: OPTION 2 - STRIPED BICYCLE LANE: Likewise, a larger portion of the shoulder could be paved, and all lanes restriped to indicate two painted bicycle lanes, one in each direction

3 West of Ridge Crest Drive

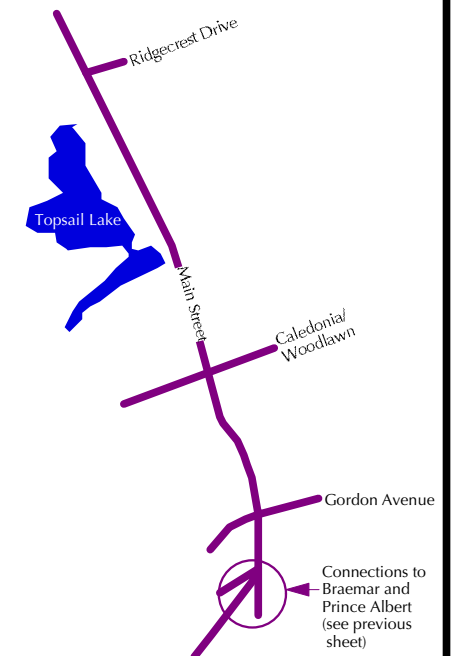

Key Map (not to scale)

MINI STUDY B:
RETROFIT OF URBAN ARTERIALS: MAIN ST., DARTMOUTH

Prepared for:
HALIFAX REGIONAL MUNICIPALITY
Date: Dec/ 02

Prepared by:
EDM ENVIRONMENTAL DESIGN AND MANAGEMENT LIMITED and **alta PLANNING + DESIGN**
B
Sheet 2 of 4