

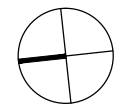

FALL RIVER SOUTH
INGRAM DRIVE, FALL RIVER, NS

SITE DEVELOPMENT PLAN

Project No.: 2016.05
Scale: 1" = 100'-0"
Date: 14 Mar 2018



WM FARES
ARCHITECTS



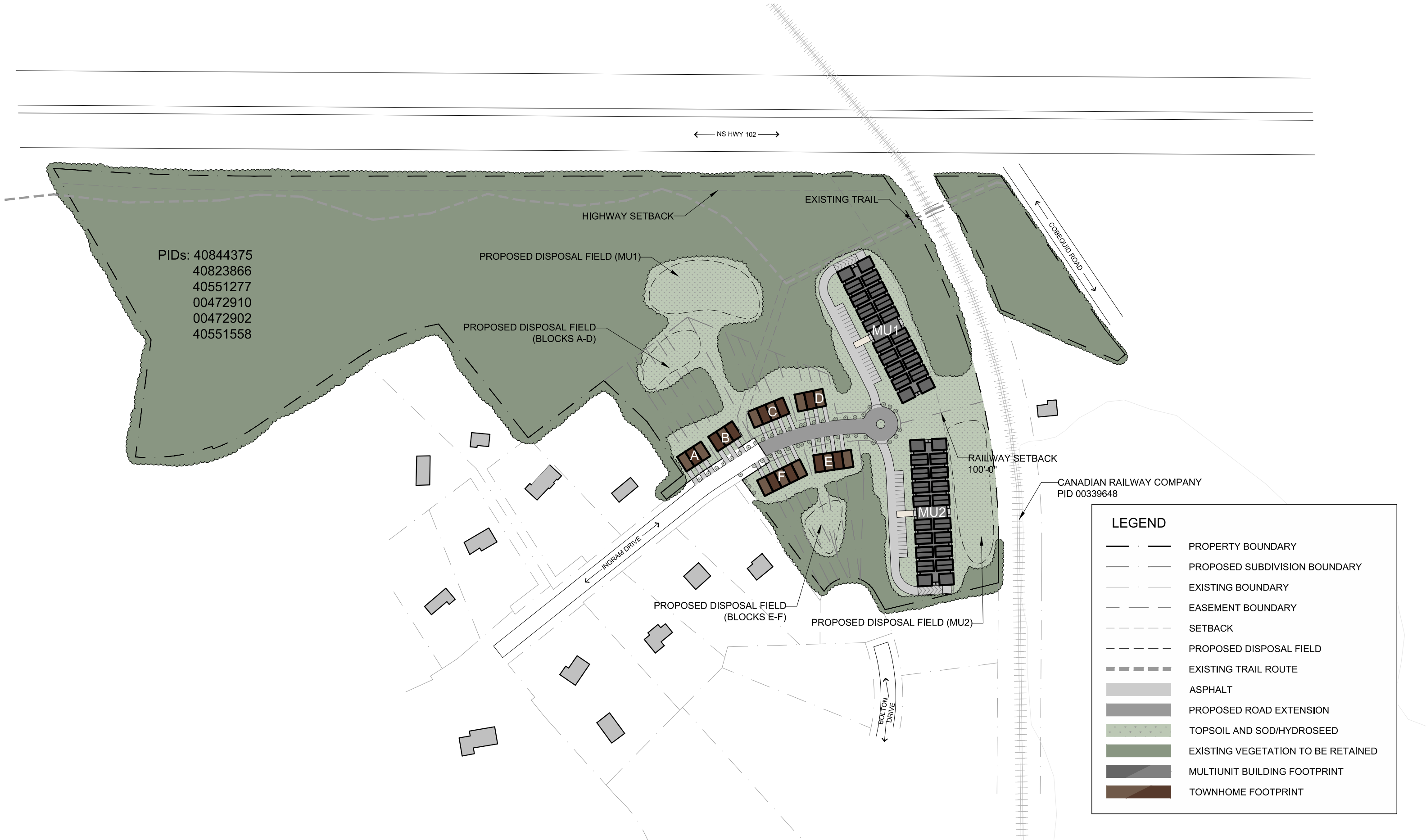

FALL RIVER SOUTH

INGRAM DRIVE, FALL RIVER, NS

KEY PLAN

Project No.: 2016.05
Scale: 1" = 200'-0"
Date: 14 Mar 2018

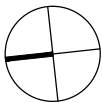

WM FARES
ARCHITECTS

SDP