

PID: 40306730  
3232975 NOVA SCOTIA LIMITED

PID: 41394081  
SISOOK HAN

KEY PLAN

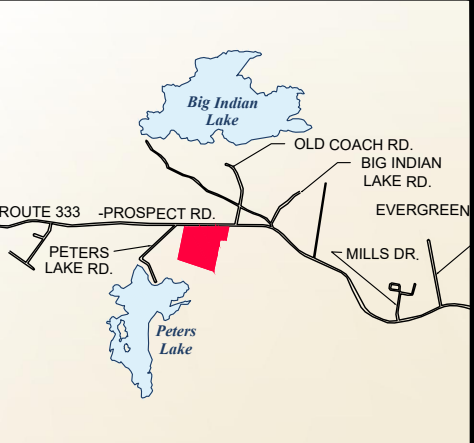

LEGEND

- Site Boundary
- Adjacent Property Boundary
- Wetland

SITE SUMMARY:

- Zone: CR-1
- Total Site Area - 14.0 Ha / 34.6 Ac
- Proposed Lot 1 Area- 10,147 m² / 2.5 Ac
- Proposed Lot 2 Area - 10,212 m² / 2.5 Ac

	BUILDING AREA	PARKING PROVIDED
C-Store	1,520 SF	7
Drive Thru	2,400 SF	41
CRU	9,236 SF	50
Total	13,156 SF	98

NOTES:

- Adjacent property lines approximate only.
- Development Agreement required.
- Well 2 is approximate 0.5m away from Building

SOURCES:

- Base plan obtained from Whyte, McElmon & Associates Lt. survey plan no. 5N11-40-1, '3782.dwg', dated Mar. 1, 2011
- Adjacent properties from provincial property mapping.

Designer: JDALZIEL  
Planner: CLOVITT

VERSION  
**2.1-B**

CONCEPT PLAN  
PROSPECT, NOVA SCOTIA

WILSON FUEL COMPANY LTD.

JULY 10, 2019 DA11307100\_V21-B

SCALE  
10 5 0 20 m  
1 : 750

NORTH



1 SPECTACLE LAKE DRIVE, DARTMOUTH, NS, CANADA B3B 1X7  
PHONE: 902 835-9955 - FAX: 902 835-1645 - WSP.COM