

LEGEND

EXISTING		PROPOSED
⊗/⊗ BF	CURB STOP/GATE/BUTTERFLY VALVE	⊗/⊗ BF
⊙	FIRE HYDRANT	⊙
↔	SIAMESE SPRINKLER CONNECTION	↔
▢/▢/○	CATCH BASIN/PIT	▢/▢/○
⊙/⊙/⊙	POWER POLE/LIGHT POLE	⊙/⊙/⊙
⊙	TREE	⊙
⊙	STREET SIGN	⊙
— GAS — GAS — GAS —	GAS LINE	— GAS — GAS — GAS —
— W — ⊗ —	WATER MAIN/SERVICE	— W — ⊗ —
○ — SAN —	SANITARY MANHOLE & PIPE	● — SAN —
□ — STM —	STORM MANHOLE & PIPE	○ — STM —
▢ — SAN/STM —	COMBINED SEWER	● — SAN/STM —
▬	PROPERTY LINE/BOUNDARY	▬
▨	BUILDING	▨

NOTES

1. EXISTING WATER, STORM & SANITARY SEWER, AND GAS UNDERGROUND PIPING BASED ON HW & HERITAGE GAS GIS DATA AND RECORDS. CONTRACTOR TO VERIFY EXACT LOCATIONS AND ELEVATIONS IN THE FIELD.
2. PROPERTY BOUNDARIES HAVE BEEN COMPILED FROM VARIOUS SOURCES AND ARE SUBJECT TO SURVEY.
3. ALL WORK SHALL BE COMPLETED IN ACCORDANCE WITH NOVA SCOTIA REGULATIONS AND HRM BY-LAWS, HALIFAX WATER DESIGN AND CONSTRUCTION SPECIFICATIONS (LATEST EDITION) AND HRM MUNICIPAL SERVICE SYSTEM GUIDELINES "RED BOOK" (LATEST EDITION).
4. CONTRACTOR TO HAVE SERVICES LOCATED IN THE FIELD PRIOR TO DIGGING.
5. CONTRACTOR TO REMOVE EXISTING LATERALS TO THE MAIN AND REMOVE OLD VALVES.

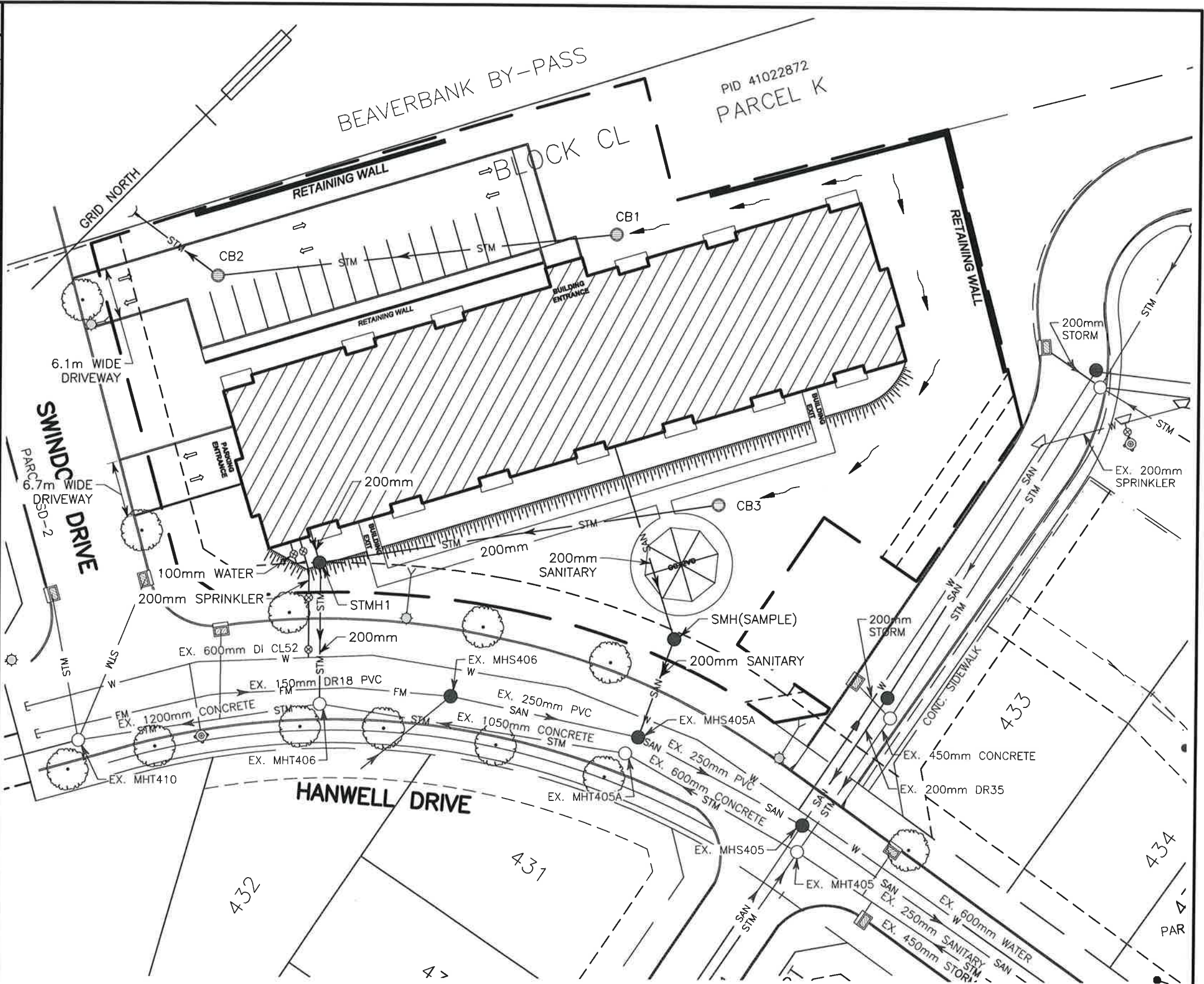

SDMM

36 OLAND CRESCENT  
BAYERS LAKE BUSINESS PARK  
HALIFAX, NOVA SCOTIA  
OFFICE: (902) 455-1537  
FAX: (902) 455-8479

HANWELL BUILDING SERVICING SCHEMATIC  
HANWELL DRIVE, MIDDLE SACKVILLE

Project No.: 1- 13- 49 (34817)  
Scale: 1:500  
Date: 13 Jan 2020

WM FARES  
ARCHITECTS

C1