

2022-12-03 16:08:54

PID: 454587
CURRENT STATUS: ACTIVE
EFFECTIVE DATE/TIME: 2012-08-10 10:34:46

ALL that certain lot of land situated on the southwestern side of the Moser River North Road, in Moser River, County of Halifax, Province of Nova Scotia and shown as a portion of Lot 8 on Plan of Division of Matthew Moser Grant dated December 1898, Surveyed by C.W. Pye, P.L.S.

PID 00454587 being more particularly described as follows:

BEGINNING at the point of intersection of the southwestern boundary of Moser River North Road with the southern boundary of Lot 9;

See Province of Nova Scotia Department of Transportation Plan showing Moser River North Road from Station 3+231.53m to Station 4+132m, dated October 19, 1984;

THENCE westerly along the southern boundary of Lot 9 to the eastern boundary of lands conveyed to Nova Scotia Department of Natural Resources;

THENCE southerly along the eastern boundary of lands conveyed to Nova Scotia Department of Natural Resources to the northern boundary of Lot 7;

THENCE easterly along the northern boundary of Lot 7 to the curved southwestern boundary of Moser River North Road;

THENCE northwesterly along the southwestern boundary of Moser River North Road on a curve to the left with a radius of 285 meters, an arc distance of 35 meters more or less to a point of curvature;

THENCE N 28 degrees, 35 minutes 40 seconds W, along the southwestern boundary, of Moser River North Road, 92 meters, more or less, to the point of beginning.

CONTAINING six and one half acres more or less.

ALL bearings are 1982 Magnetic Bearings.

THE above described PID 00454587 being a portion of Lot 8, lands conveyed to Jean Jewers and Carol Laver by indenture dated the 17th day of January, 1981 recorded in the Halifax County Land Registration Office in Book 3463 Page 1247.

*** Municipal Government Act, Part IX Compliance ***

Compliance:

The parcel originates with an instrument (registration details below) and the subdivision is validated by Section 291 of the Municipal Government Act

Registration District: HALIFAX COUNTY
Registration Year: 1898
Book: 325 Page: 558 Document Number: 1608

2022-12-03 16:08:54

External Comments:

Description Change Details:

Reason:

Author of New or

Changed Description:

Name:

Registered Instruments:

Comments:

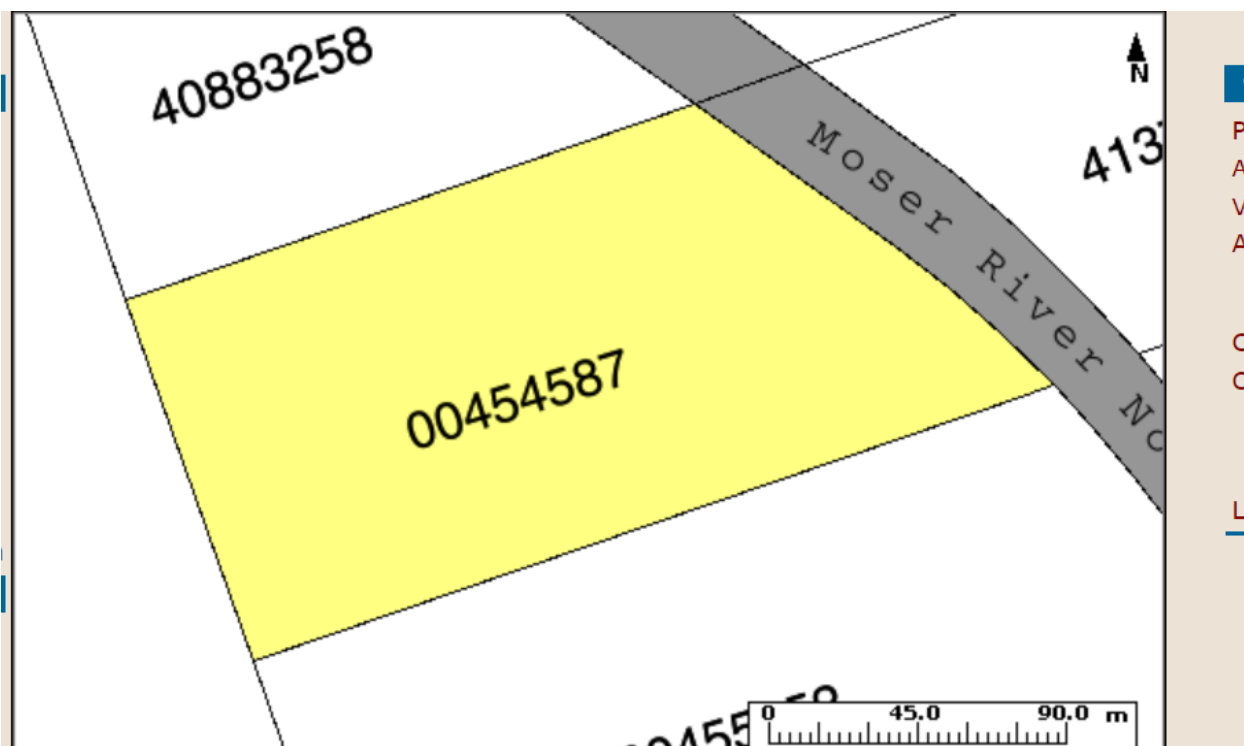

Lat: Long: Scale: [Go](#) Zoom:

The Provincial mapping is a graphical representation of property boundaries which approximate the size, configuration and location of parcels. Care has been taken to ensure the best possible quality, however, this map is not a land survey and is not intended to be used for legal descriptions or to calculate exact dimensions or area. The Provincial mapping is not conclusive as to the location, boundaries or extent of a parcel [*Land Registration Act* subsection 21(2)]. THIS IS NOT AN OFFICIAL RECORD.