

## **SCHEDULE "A"**

**ALL** that certain piece or parcel of land, situate, lying and being at Quoddy, County of Halifax, Province of Nova Scotia, and more particularly described as follows;

**BEGINNING** at a post, said post being at the Junction of "Salmon Hole Road", so called, and the main Highway # 7;

**THENCE** north to a post placed at "Deep Hole", Quoddy River;

**THENCE** east three hundred fifty (350) feet, more or less, to a post;

**THENCE** south one hundred eighty (180) feet , more or less, to a post;

**THENCE** west three hundred fifty (350 ) feet, more or less, to the place of beginning;

**BEING AND INTENDED TO BE** that certain piece or parcel of land, conveyed by Warranty Deed dated September 14, 2005 by Kenneth G. Hartling , to Kenneth G. Hartling, and his son, Gavin K.Hartling, as Joint Tenants and not as Tenants in Common, and Registered at the Registry of Deeds, Halifax, N.S., on Sept. 20, 2005, as Document # 83045568.

Reference is made to Document No. 114571905.

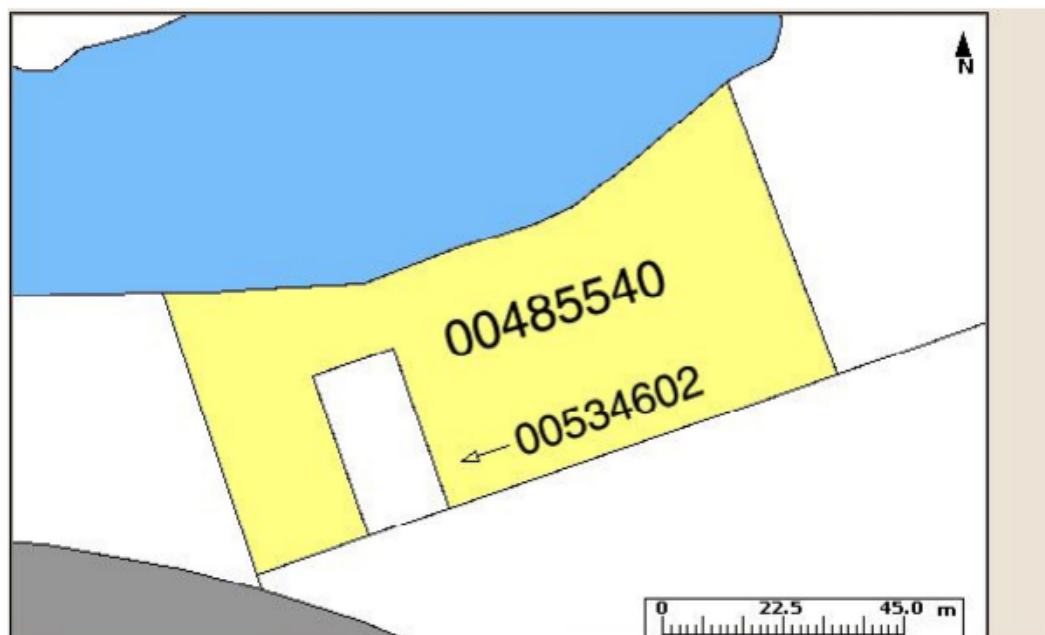

Lat: 44-55-38N

Long: 62-20-42W

Scale: 1121

Go Zoom: 2 ▼

The Provincial mapping is a graphical representation of property boundaries which approximate the size, configuration and location of parcels. Care has been taken to ensure the best possible quality, however, this map is not a land survey and is not intended to be used for legal descriptions or to calculate exact dimensions or area. The Provincial mapping is not conclusive as to the location, boundaries or extent of a parcel [*Land Registration Act* subsection 21(2)]. THIS IS NOT AN OFFICIAL RECORD.