

EXISTING BUILDING - 10,156 SF  
BUILDING EXPANSION - 7,665 SF  
FUTURE PARKING - 85 STANDARD / 6 BF

[illegible]

7071 Bayers Rd. Suite 3004  
Halifax, NS B3L 2C2

Phone: (902) 444-0555  
Fax: (902) 444-7522

**hA**  
harveyARCHITECTURE

|                                  |            |
|----------------------------------|------------|
| GATEWAY MEAT MARKET<br>EXPANSION |            |
| 667 MAIN ST, WETPHAL NS          |            |
| SITE PLAN                        |            |
| Project Number                   | 23027      |
| Date                             | 2023.04.27 |
| Drawn By                         | TC         |
| Checked By                       | CD         |

|       |              |
|-------|--------------|
| Scale | As indicated |
|-------|--------------|

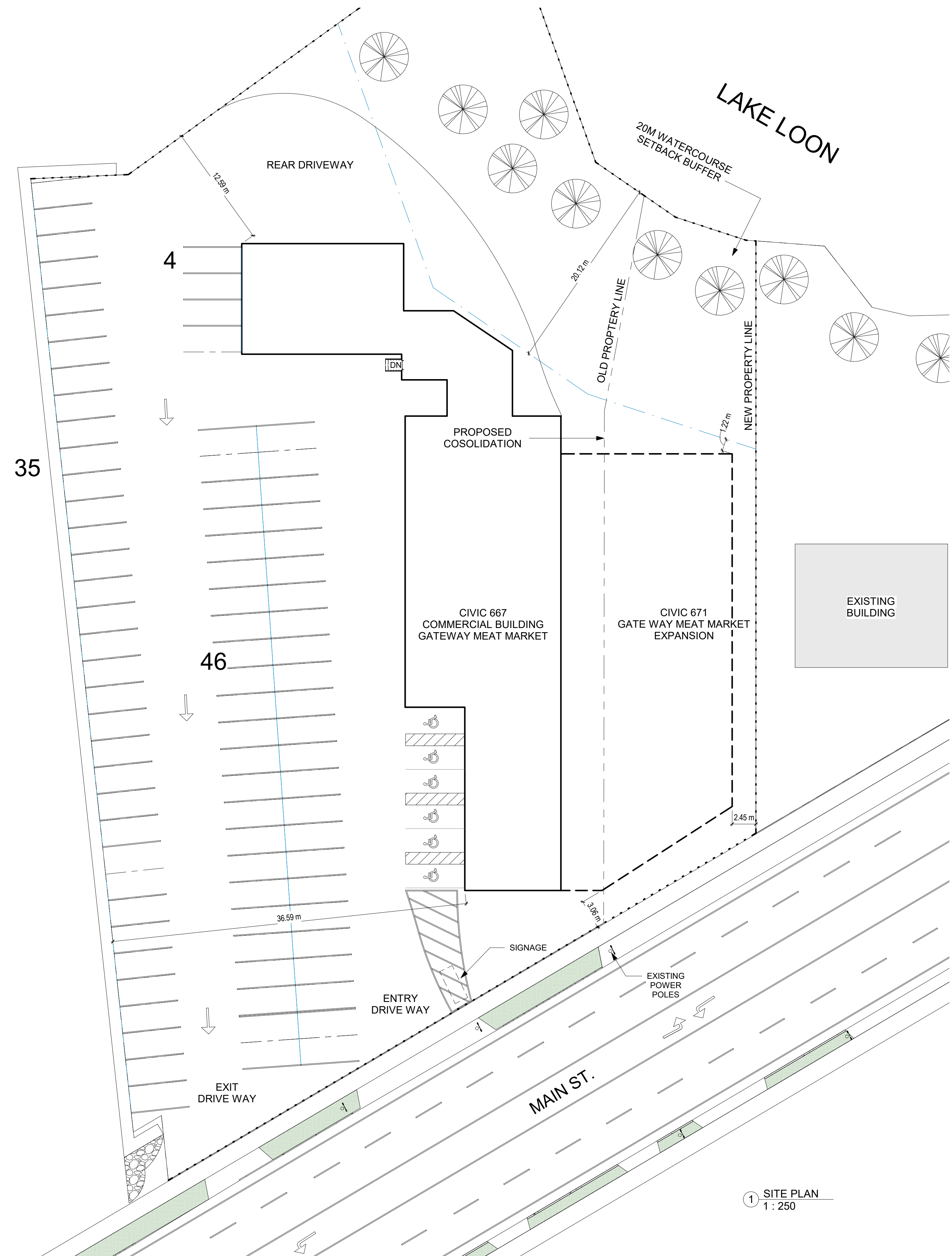

1 SITE PLAN  
1 : 250