

PROJECT DATA				
NUMBER OF UNITS PROVIDED				
LEVEL	1 BDR	2 BDR	2 BDR + DEN	TOTAL
100	-	11	2	13
200	-	11	2	13
300-400	2	22	4	28
<b>TOTALS:</b>	<b>2 (4%)</b>	<b>44 (81%)</b>	<b>8 (15%)</b>	<b>54</b>
SITE DATA				
PROPERTY AREA				60 653 SF
BUILDING AREA				17 124 SF
LOT COVERAGE				28%
AMENITY SPACE PROVIDED				
OUTDOOR				12 600 SF
AMENITY ROOMS				1 400 SF
<b>TOTAL:</b>				<b>14 000 SF</b>
PARKING SPACES PROVIDED				
EXTERIOR				15
INTERIOR				52
<b>TOTAL:</b>				<b>67</b>

HANWELL DRIVE  
HANWELL DRIVE, MIDDLE SACKVILLE NS

SITE DEVELOPMENT PLAN

Project No: 2017-11  
Scale: As indicated  
Date: JANUARY 2020

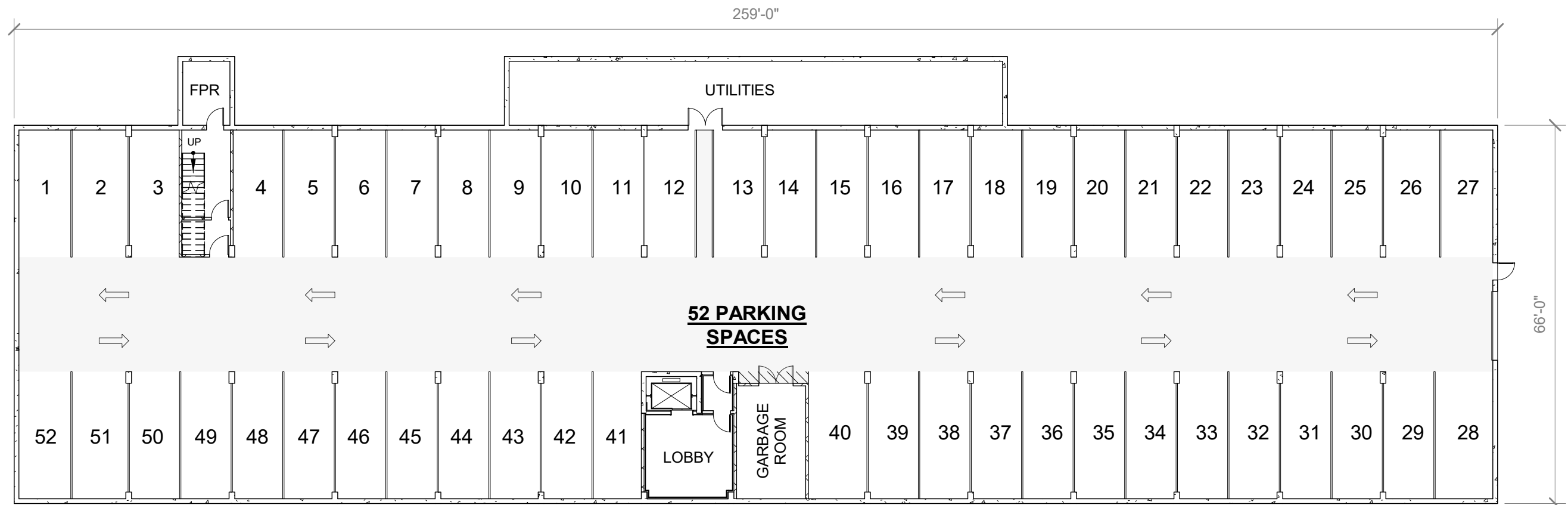

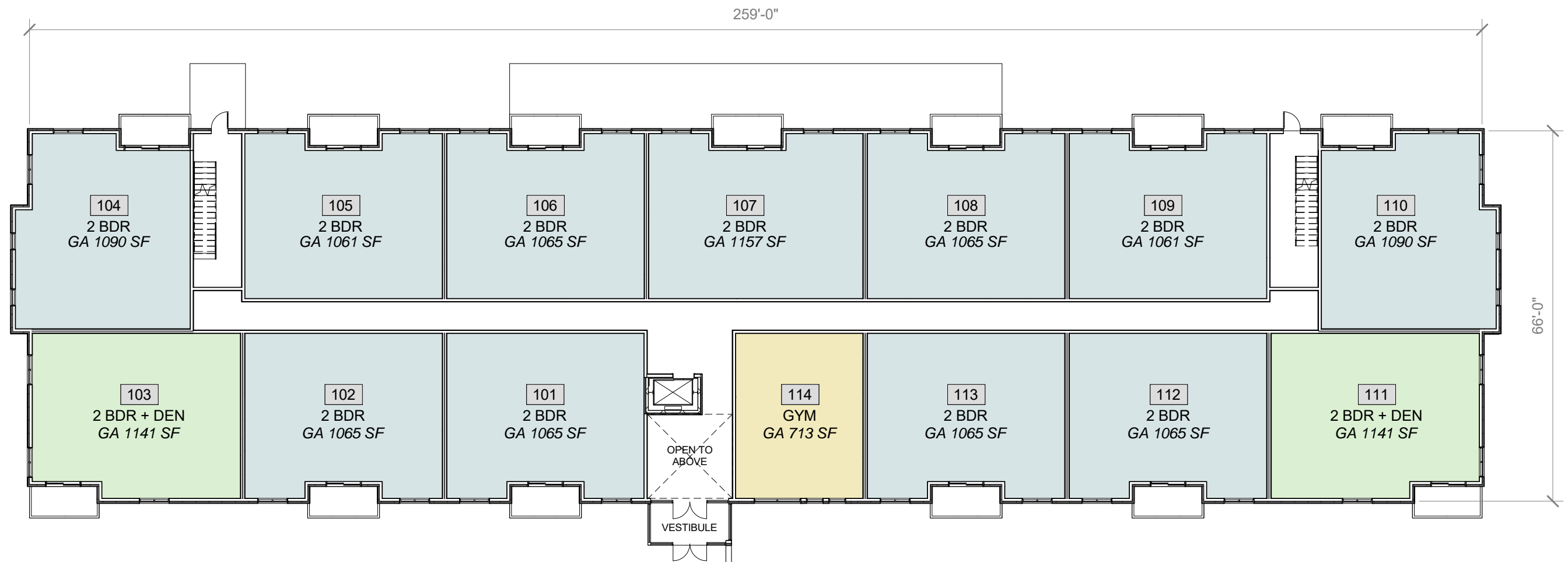

HANWELL DRIVE

HANWELL DRIVE, MIDDLE SACKVILLE NS

FLOOR PLAN - LEVEL 100

Project No: 2017-11

Scale: 1" = 20'-0"

Date: JANUARY 2020

WM FARES ARCHITECTS **A102**

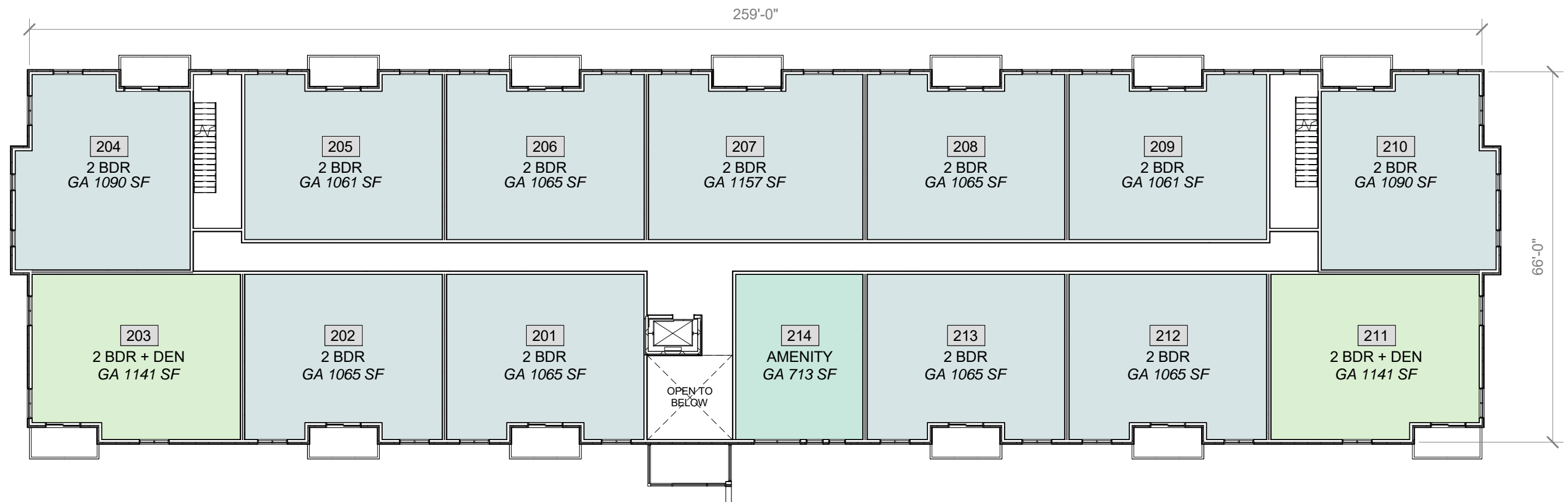

HANWELL DRIVE

HANWELL DRIVE, MIDDLE SACKVILLE NS

FLOOR PLAN - LEVEL 200

Project No: 2017-11

Scale: 1" = 20'-0"

Date: JANUARY 2020

WM FARES ARCHITECTS **A103**

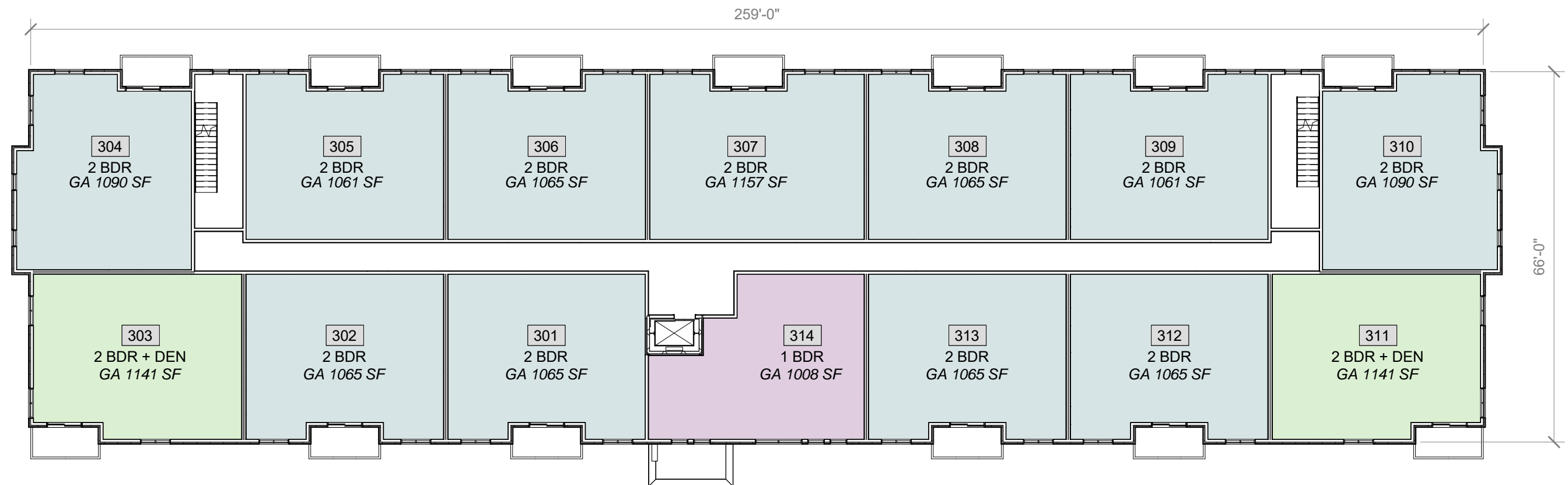

HANWELL DRIVE

HANWELL DRIVE, MIDDLE SACKVILLE NS

FLOOR PLAN - LEVEL 300-400

Project No: 2017-11

Scale: 1" = 20'-0"

Date: JANUARY 2020

WM FARES ARCHITECTS **A104**



HANWELL DRIVE  
HANWELL DRIVE, MIDDLE SACKVILLE NS

ELEVATION - FRONT

Project No: 2017-11  
Scale: 1" = 20'-0"  
Date: JANUARY 2020

WM FARES **A301**  
ARCHITECTS



HANWELL DRIVE  
HANWELL DRIVE, MIDDLE SACKVILLE NS

ELEVATION - REAR

Project No: 2017-11  
Scale: 1" = 20'-0"  
Date: JANUARY 2020

WM FARES **A302**  
ARCHITECTS



HANWELL DRIVE

HANWELL DRIVE, MIDDLE SACKVILLE NS

ELEVATION - SIDES

Project No: 2017-11

Scale: 1" = 20'-0"

Date: JANUARY 2020

WM FARES ARCHITECTS **A303**