

HALIFAX REGIONAL MUNICIPALITY
ADMINISTRATIVE ORDER NUMBER SC15

RESPECTING THE CLOSURE OF A PORTION OF
ROBIE STREET, HALIFAX, NOVA SCOTIA

BE IT RESOLVED AS AN ADMINISTRATIVE ORDER of Council of the Halifax Regional Municipality pursuant to Section 147 of the Halifax Regional Municipality Act as follows:-

1. The “subject lands”, 1377 to 1403 Robie Street and 5991 College Street, Halifax, Nova Scotia, more particularly described in Map “A: is hereby closed.

I HEREBY CERTIFY THAT the foregoing Administrative Order was duly adopted by Halifax Regional Council, the 12th day of January, 1999.

MAYOR

MUNICIPAL CLERK

I, Vi Carmichael, Municipal Clerk of the Halifax Regional Municipality, hereby certify that the above-noted Administrative Order was passed at a meeting of Halifax Regional Council held on January 12, 1999.

Vi Carmichael, Municipal Clerk

(Portion of) Robie Street
College Street, Robie Street and Spring Garden Road, Halifax, Nova Scotia

All that certain parcel of land being on the eastern side of Robie Street lying between College Street and Spring Garden Road, Halifax, Nova Scotia shown as a portion of Robie Street on City of Halifax Official Plan, Section 17-F dated February 10, 1969 and confirmed by City Council on March 12, 1969. The portion of Robie Street to be closed is described as follows:

BEGINNING at the intersection of the eastern official (1911) street line of Robie Street and the northern official (1911) street line of College Street;

thence northerly along the eastern official (1911) street line of Robie Street to the southern official (1911) street line of Spring Garden Road;

thence easterly along the southern official (1911) street line of Spring Garden Road to a point on the prolongation of the eastern official (1969) street line of Robie Street;

thence continuing easterly along the southern official (1911) street line of Spring Garden Road, ten feet;

thence southwesterly along the southeastern official (1969) street line of Robie Street to a point being 12.0 feet from the eastern official (1911) street line of Robie Street and ten feet from the southern official (1911) street line of Spring Garden Road;

thence southerly along the eastern official (1969) street line of Robie Street to a point being 10.0 feet from the eastern official (1911) street line of Robie Street and ten feet from the northern official (1911) street line of College Street;

thence southeasterly along the northeastern official (1969) street line of Robie Street to the northern official (1911) street line of College Street;

thence westerly along the northern official (1911) street line of College Street to the point of beginning.

The portion of Robie Street to be closed refers to Halifax Regional Municipality Administrative Order Number SC15 adopted by Halifax Regional Council on January 12, 1999.



MAP "A"

Spring Garden Road

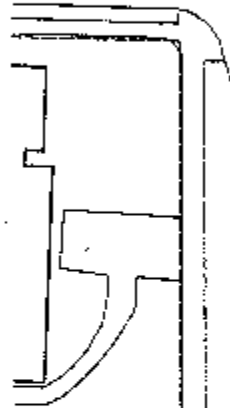
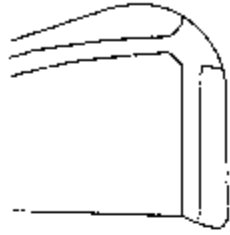

Robie Street

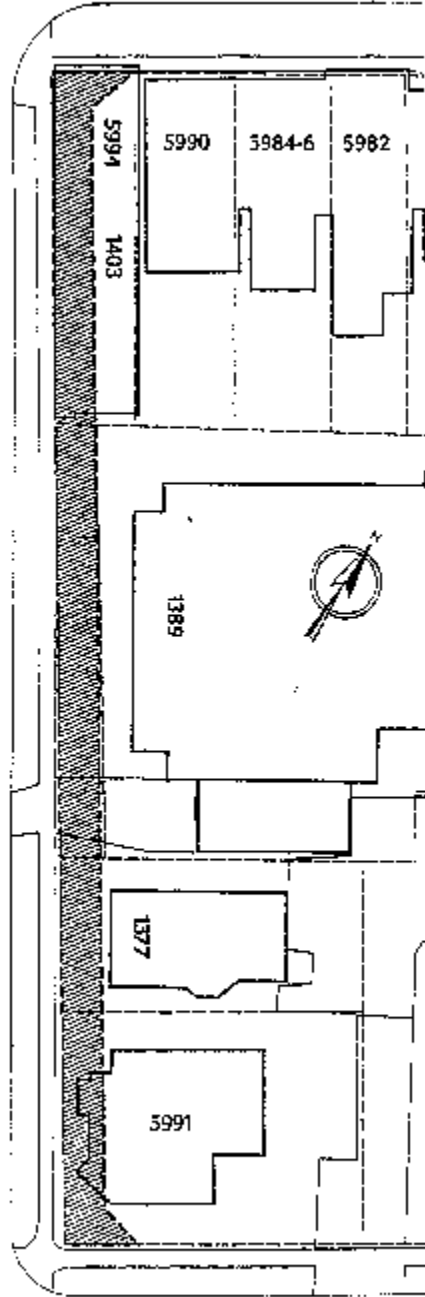

College Street