

HALIFAX REGIONAL MUNICIPALITY
ADMINISTRATIVE ORDER NUMBER #SC-085

RESPECTING CLOSURE OF A PORTION OF
METROPOLITAN AVENUE, SACKVILLE

BE IT RESOLVED AS AN ADMINISTRATIVE ORDER of Council of the Halifax Regional Municipality pursuant to Section 325 of the Halifax Regional Municipality Charter Act as follows:

1. A portion of Metropolitan Avenue, Sackville, Nova Scotia more particularly described in Attachment "C", is hereby closed.

I HEREBY CERTIFY THAT the foregoing Administrative Order was duly adopted by Halifax Regional Council, the 5th day of September, 2017.

Mayor

Acting Municipal Clerk

I, Sherryll Murphy, Acting Municipal Clerk of Halifax Regional Municipality, hereby certify that the above-noted Administrative Order was passed at a meeting of Halifax Regional Council held on September 5, 2017.

Sherryll Murphy, Acting Municipal Clerk

Notice of Motion:
Approved:

August 1, 2017
September 5, 2017

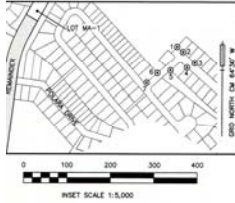

ADDITIONAL EVIDENCE LOCATED			
POINT NUMBER	Northing	Easting	Description
1	4960478.118	5565806.871	SURVEY MARKER FOUND
2	4960532.091	5565822.712	SURVEY MARKER FOUND
3	4960579.836	5565836.287	SURVEY MARKER FOUND
4	4960484.870	5565845.076	SURVEY MARKER FOUND
5	4960485.352	5565863.495	SURVEY MARKER FOUND
6	4960471.888	5565776.846	SURVEY MARKER FOUND
7	4960402.134	5565752.184	SURVEY MARKER FOUND

INSET SCALE 1:5,000

APPROVAL STAMPS



BLOCK A - SACKVILLE LAKES PROVINCIAL PARK
HER MAJESTY THE QUEEN IN RIGHT OF THE PROVINCE OF NOVA SCOTIA
LRO DOC # 108794-830



LEGEND

- BOUNDARIES DEALT WITH BY THIS SURVEY
- SURVEY MARKER
- N.S.C.M. NOVA SCOTIA COORDINATE MONUMENT
- IRON BAR
- FOUND
- PLACED
- UTILITY POLE
- METERS SQUARED
- TE LINES
- WALLACE, MACDONALD AND LINDY
- CALCULATED POINT
- PD SURVEY IDENTIFICATION NUMBER
- POINT OF CURVATURE
- REGISTRY OF GEOL. LAND REGISTRY OFFICE
- RIGHT OF WAY
- OVERHEAD LINES
- HALIFAX WATER MAINHOLE
- WOOD FENCE

BEARINGS, DISTANCES AND COORDINATES SHOWN ARE NOVA SCOTIA 3rd ORDER TRANSVERSE MERCATOR VALUES DERIVED FROM COORDINATIONS TO NOVA SCOTIA COORDINATE MONUMENT NUMBERS 22820, 22479 AND 22278 USING THE 1979 ADJUSTMENT IN THE 1977 DATUM. A CORRECTION SCALE FACTOR OF 0.99848 WAS APPLIED TO MEASURED DISTANCES. MEASUREMENTS SHOWN HAVE BEEN ADJUSTED BY LEAST SQUARES.

- NOTES**
- IDENTIFIER LOT MA-1 ORIGINATES WITH THIS PLAN.
 - LOT MA-1 IS A PORTION OF METROPOLITAN AVENUE TO BE CLOSED.
 - GRAPHIC DISPLAY AS SHOWN ON PROPERTY OR LINE APPEARS INCONSISTENT WITH RECORD CORRESPONDING.
 - SEE SERVANT DUMBRICK & MACHIONE PLAN OF METROPOLITAN AVENUE DATED JANUARY 17, 1972 ATTACHED TO BOOK 2820 PAGE 379.

SURVEYOR'S CERTIFICATE

I, FRANK G. SULLS, NOVA SCOTIA LAND SURVEYOR, HEREBY CERTIFY THAT THE SURVEY REPRESENTED BY THIS PLAN WAS CONDUCTED UNDER MY SUPERVISION, AND THAT THE SURVEY AND PLAN HERE MADE IN ACCORDANCE WITH THE LAND SURVEYORS ACT, REGULATIONS AND STANDARDS MADE THEREUNDER, DATED THIS 10th DAY OF DECEMBER, A.D. 2014.

Frank G. Sullis N.S.L.S.



HALIFAX

PLAN OF SURVEY OF
LOT MA-1
A CLOSURE OF A PORTION OF
METROPOLITAN AVENUE
LANDS CONVEYED TO
HALIFAX REGIONAL MUNICIPALITY
METROPOLITAN AVENUE
SACKVILLE NOVA SCOTIA

REMANDED SKETCH SCALE 1:5,000

28/09/2014	Scale 1:5,000	Drawn gsu	Plan No.
REVIEWED	SUPERVISOR	JOB No.	14016101